

best locking solutions

Cabinet Security

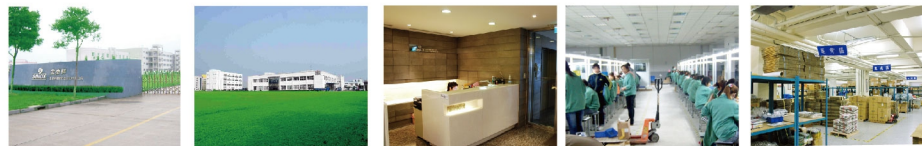

SINOX COMPANY LTD. ISO 9001:2015

Taiwan Headquarter / Factory

3F, No. 2, Lane 93, Chien-I Road, Chung-Ho Dist., New Taipei City, 23585, Taiwan

TEL: +886.2.8227.6730 FAX: +886.2.8227.6729 Email: info@sinoxlock.com Website: <http://www.sinoxlock.com>

China Factory

No. 876, Huayuan Road, Zhangpu Town, Kunshan City, Jiangsu Province, P.R. China

post code: 215321 TEL: +86.512.5745.2310 FAX: +86.512.5745.2318



Auto-Zero-Return

NEW

- Fixcode-Private
- Metal panel



AL269	
code	4-dials resettable combination
material	Lock housing: Zinc Alloy / Plastic dials
feature/function	Decode function
	Accessed with override emergency key
	Interchangeable key cylinder (upon request)
	With green(open) and red (lock) indicator

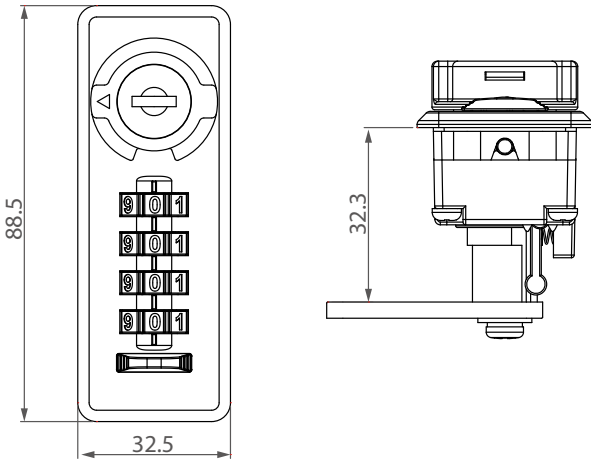

AL267	
code	4-dials resettable combination
material	Lock housing: Plastic / Plastic dials
feature/function	Decode function
	Accessed with override emergency key
	Interchangeable key cylinder (upon request)

NEW

- Fixcode-Private
- Plastic Panel

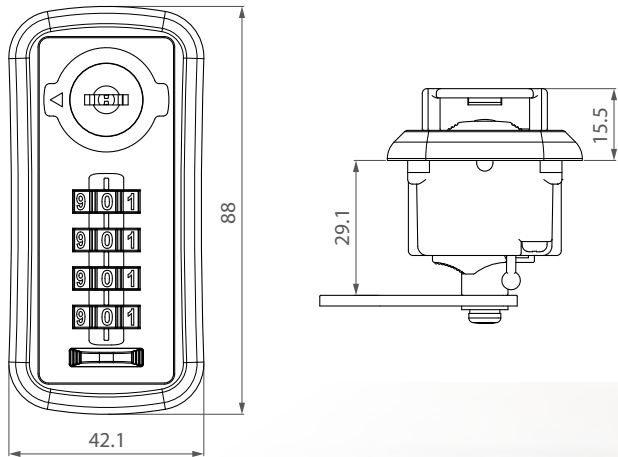

NEW

- Free mode-Public
- Metal panel



AL260	
code	4-dials resettable combination
material	Lock housing: Zinc Alloy / Plastic dials
feature/function	Decode function
	Accessed with override emergency key
	Interchangeable key cylinder (upon request)
	With green(open) and red(lock) indicator
	Auto-Reset

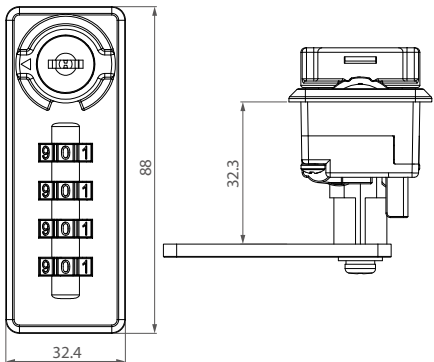

All In Front

NEW • Fixcode-Private
• For Metal Cabinet



AL311



code	4-dials resettable combination
material	Lock housing: Plastic / Plastic dials
feature/function	Decode function
	Accessed with override emergency key
	Combination reset in front
	Scramble-locking

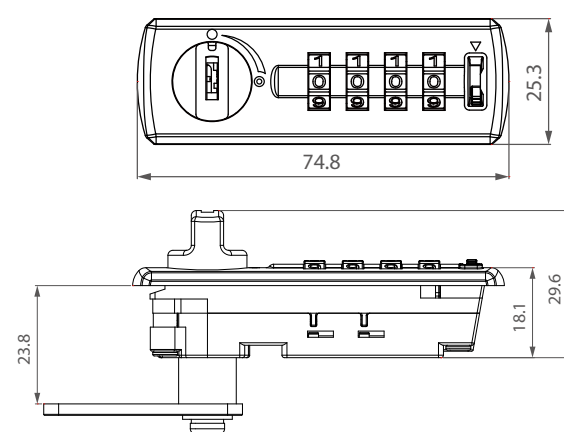

AL311 Slam Lock



code	4-dials resettable combination
material	Lock housing: Plastic / Plastic dials
feature/function	Decode function
	Accessed with override emergency key
	Combination reset in front
	Scramble-locking

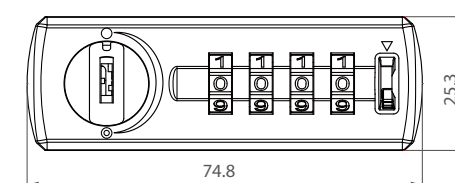

Lock with Bolt

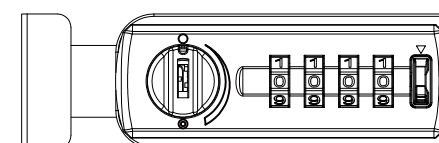

Slam lock

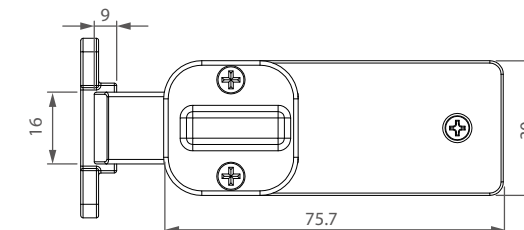
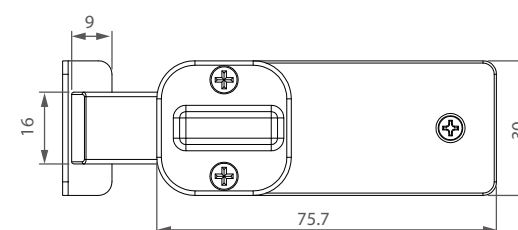
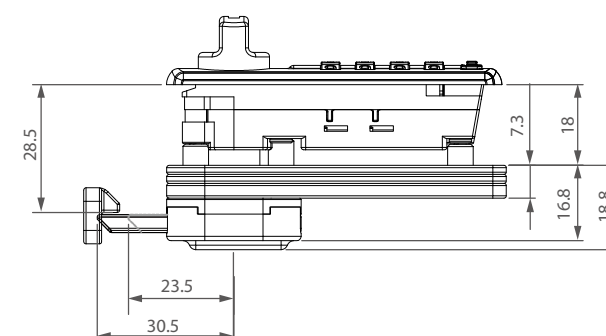
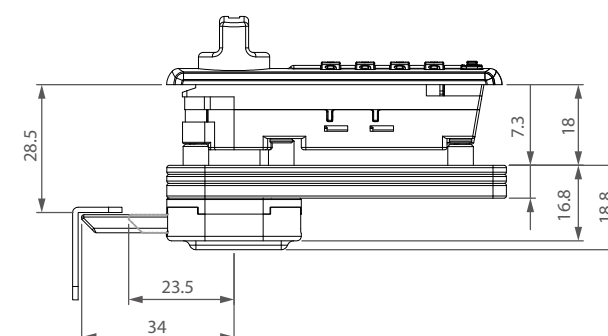
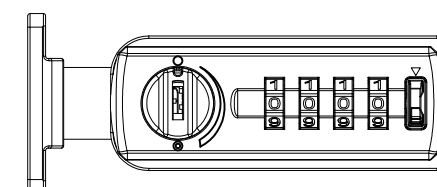

AL320



code	4-dials resettable combination
material	Lock housing: Plastic / Plastic dials
feature/function	Decode function
	Accessed with override emergency key
	Auto-Reset

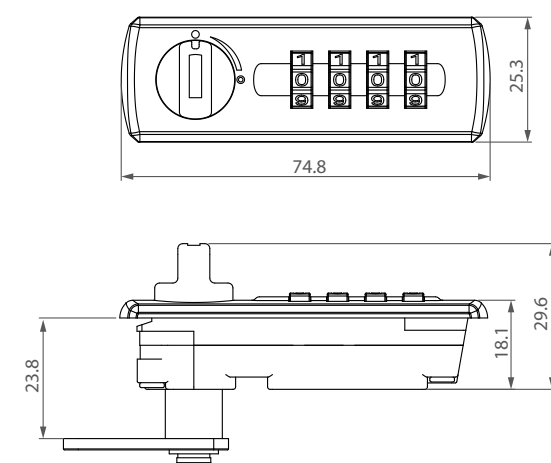

NEW • Free mode-Public
• For Metal Cabinet



AL320(R)

AL320(L)

AL320(V)

AL320(U)

NEW • Fixcode-Private
• For Metal & Wooden Cabinet



AL312(R)



AL312(L)

AL312



code	4-dials resettable combination
material	Lock housing: Plastic / Plastic dials
feature/function	Decode function
	Accessed with override emergency key
	Combination reset in front
	Scramble-locking

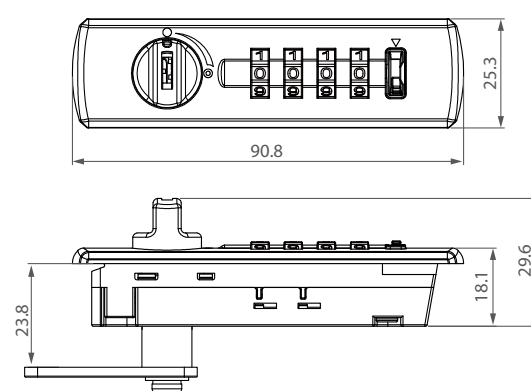

NEW • Free mode-Public
• For Metal & Wooden Cabinet



AL321(R)



AL321(L)

AL321



code	4-dials resettable combination
material	Lock housing: Plastic / Plastic dials
feature/function	Decode function
	Accessed with override emergency key
	Auto-Reset

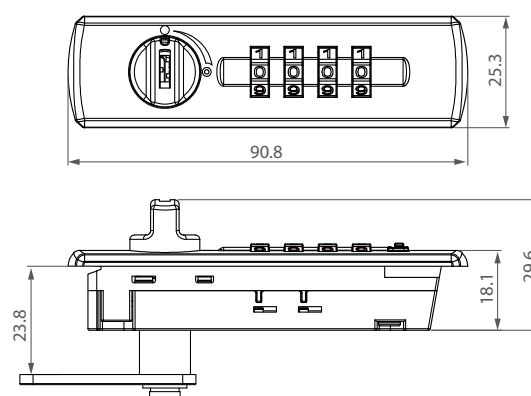

NEW • Fixcode or Free mode
• Push To Lock for Sliding Door



AL330



code	4-dials resettable combination
material	Lock housing: Plastic / Plastic dials
feature/function	Decode function
	Accessed with override emergency key
	Auto-Reset or fixed code
	Push and turn to lock

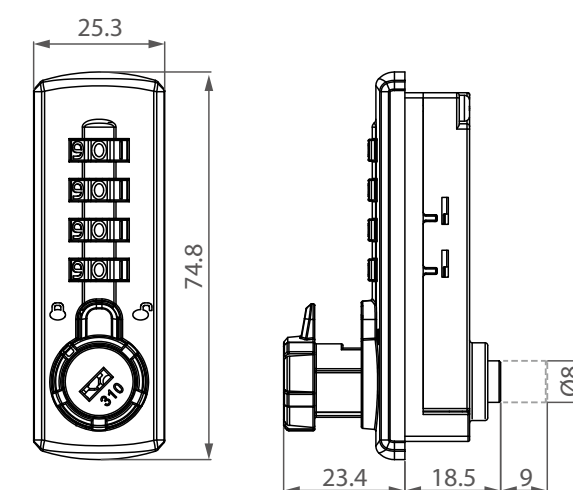

High Security Lock



AL268



code	4-dials resettable combination
material	Lock housing: Zinc Alloy / Metal dials
feature/function	Decode function
	Accessed with override emergency key
	➤ Auto-Reset
	➤ Fixed code- Scramble locking

FEATURE

- Dual Mode Switchable
- Scramble Locking

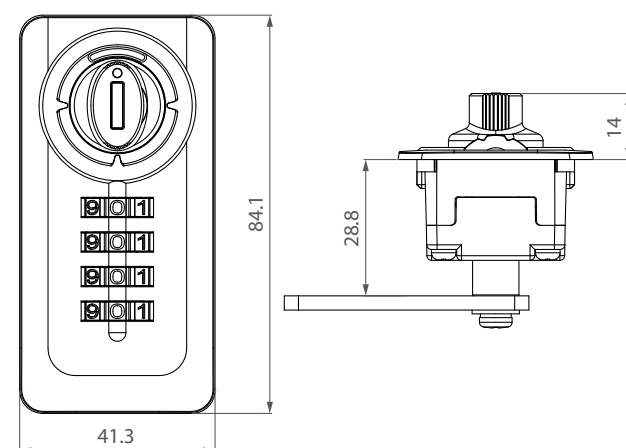

FEATURE

- Dual Mode Switchable
- Interchangeable Cylinder



AL238(R)



AL238(V)

FEATURE

- Dual Mode Switchable
- Handle



AL239(V)

AL238



code	4-dials resettable combination
material	Lock housing: Zinc Alloy / Plastic dials
feature/function	Decode function
	Accessed with override emergency key
	Interchangeable key cylinder (upon request)
	Auto-Reset or fixed code

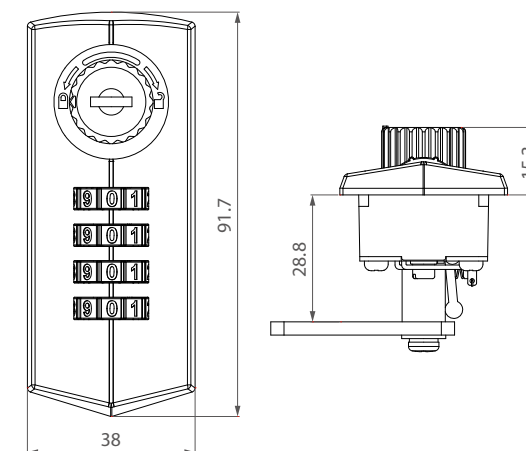

AL239



code	4-dials resettable combination
material	Lock housing: Zinc Alloy / Plastic dials
feature/function	Decode function
	Accessed with override emergency key
	Interchangeable key cylinder (upon request)
	Auto-Reset or fixed code

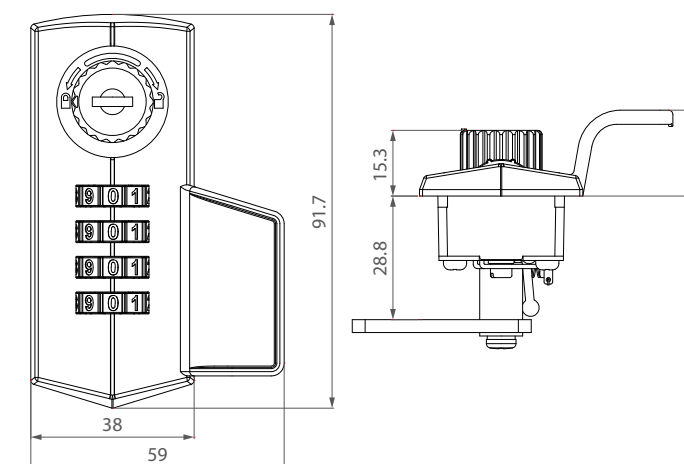

Flexible Solution

AL224



code	4-dials resettable combination
material	Lock housing: Plastic / Plastic dials
feature/function	Decode function
	Accessed with override emergency key



AL224B(R)



AL224B(L)



AL224B(V)

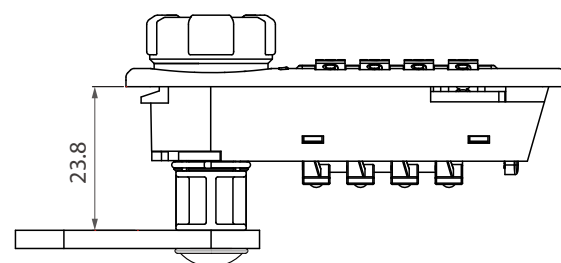
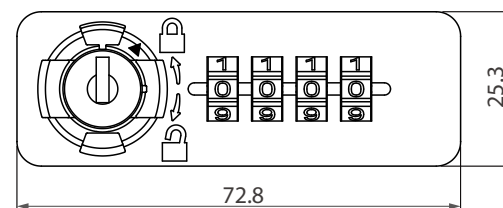

(metal)

(wooden)

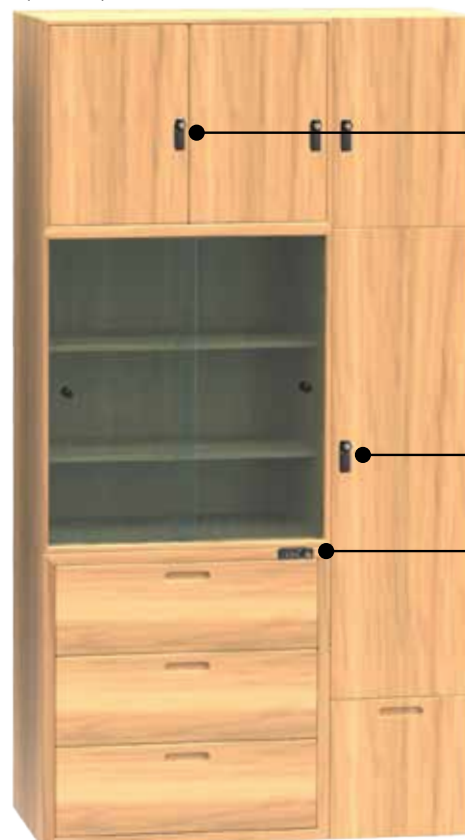

AL224(V)

AL224(V)

AL224C(L)

AL224S



code	4-dials resettable combination
material	Lock housing: Plastic / Plastic dials
feature/function	Decode function
	Accessed with override emergency key



AL224S(V)

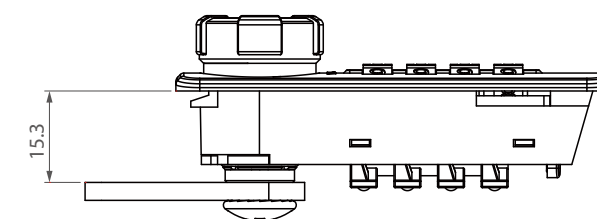

AL224C



code	4-dials resettable combination
material	Lock housing: Plastic / Plastic dials
feature/function	Decode function
	Accessed with override emergency key



AL224C(L)

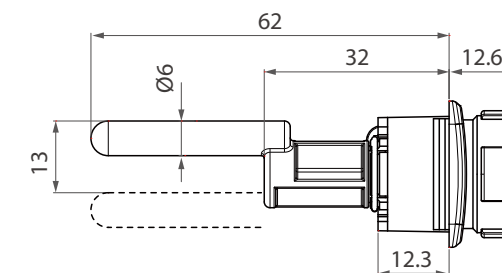

**AL233**

code	4-dials resettable combination
material	Lock housing: Plastic / Plastic dials
feature/function	With green (open) and red (lock) indicator
	Decode function
	Accessed with override emergency key
	Interchangeable key cylinder (upon request)
	Auto-Reset or fixed code

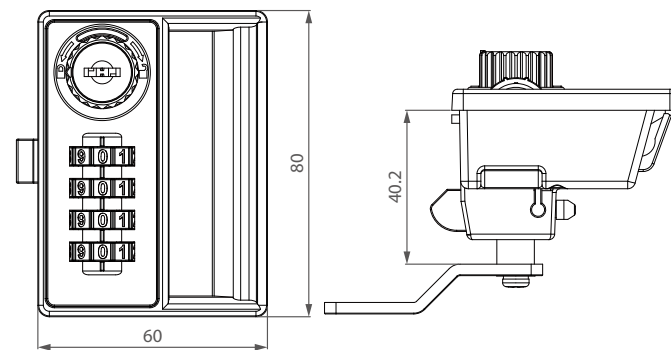
**AL237**

code	4-dials resettable combination
material	Lock housing: Plastic / Plastic dials
feature/function	With green (open) and red (lock) indicator
	Decode function
	Accessed with override emergency key
	Interchangeable key cylinder (upon request)
	Auto-Reset or fixed code

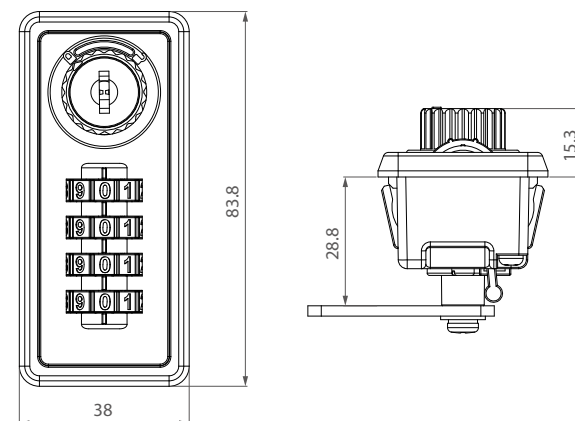

AL237(R)



AL237(L)



AL237(V)





AL205



code	4-dials resettable combination
material	Lock housing: Plastic / Plastic dials
feature/function	Decode function in front
	Accessed with override emergency key
	Scramble-locking

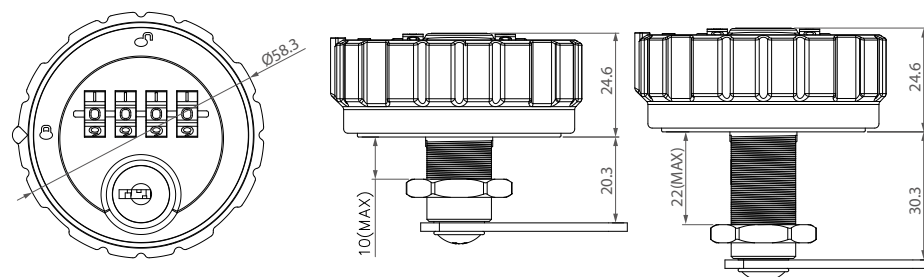

AL202(D)



AL202(U)

AL202



code	3-dials resettable combination
material	Lock housing: Zinc Alloy / Plastic dials
feature/function	Black coated or nickle plated

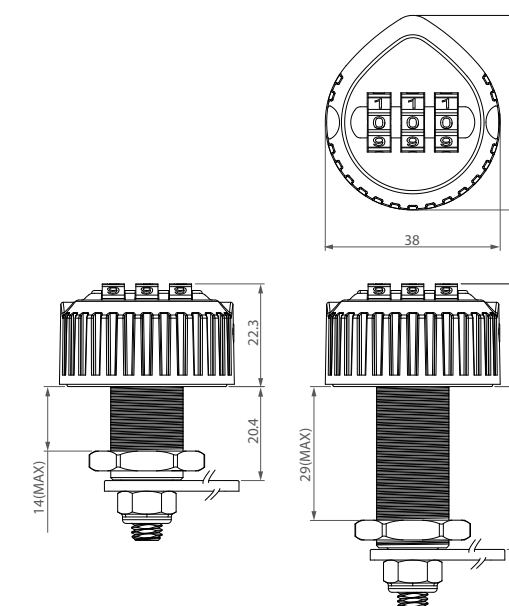

AL305



code	4-dials resettable combination
material	Lock housing: Zinc alloy / Metal dials
feature/function	Decode function in front
	Accessed with override emergency key
	Scramble-locking

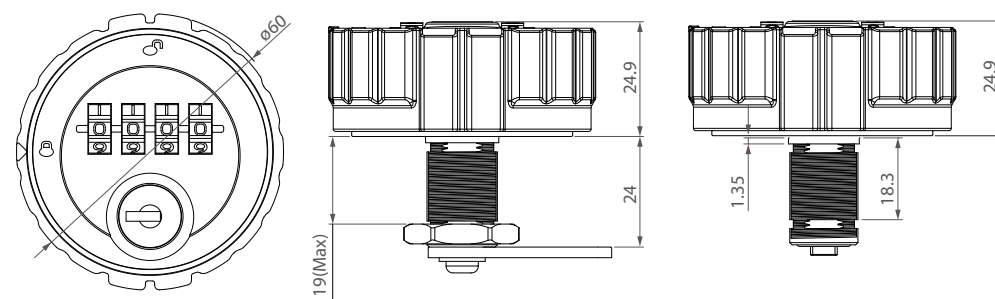

◀AL204P



◀AL204

AL204



code	3-dials resettable combination
material	Lock housing: Plastic / Plastic dials
feature/function	Decode function in front
	Accessed with override emergency key
	Scramble-locking

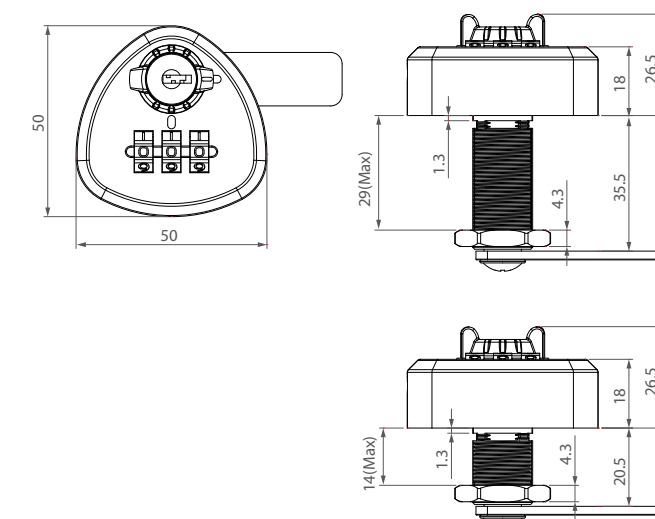

Key Box

- Set your own combination for keyless convenience and increased security
- Shutter door protects combination dials from water, dirt and grime
- Hold up key / cardkey for house or car in a convenient location for regular use
- Applications: wall mount (w/ screws), over the door knob (w/ shackle) and hanging on the car window (w/ steel plate)

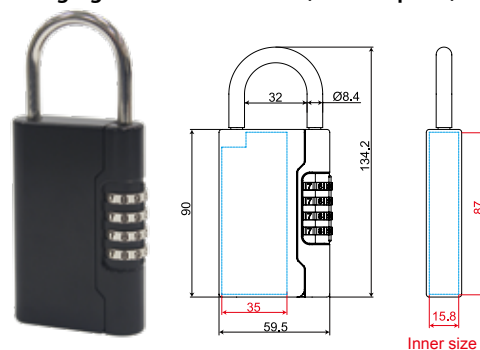

PL960
Shackle size: Ø10 mm
W59.5 x D19 x H134.2 mm
Inner size: W35 x D15.8 x H87 mm

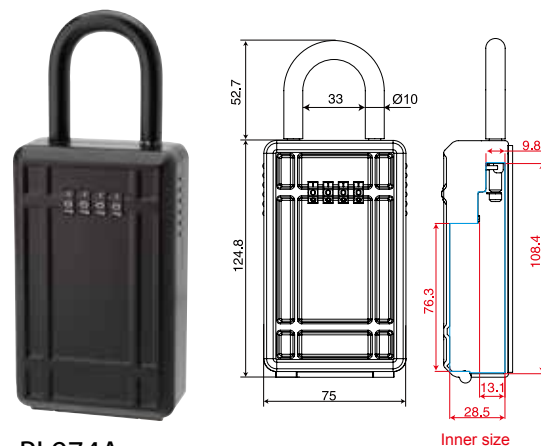

PL974A
Shackle size: Ø10 mm
W75 x D33.35 x H177.5 mm
Inner size: W71.2 x D28.5 x H108.4 mm

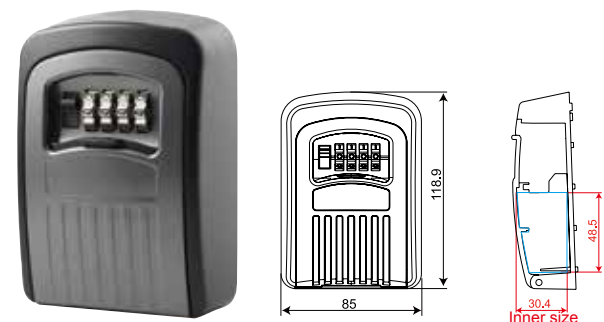
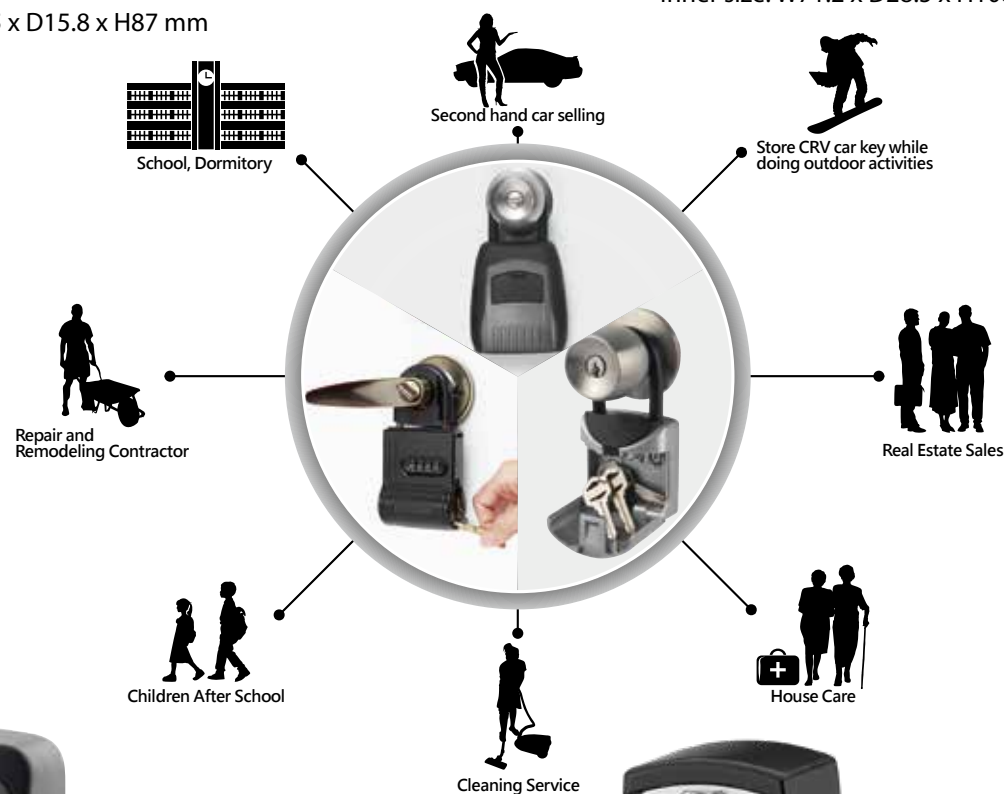

PL967
W85 x D35.9 x H118.9 mm
Inner size: W64.7 x D30.4 x H48.5 mm



PL998
W83.5 x D49 x H121.5 mm
Inner size: W54 x D26.5 x H100 mm

Locker PadLock

- Keyed alike available
- Set your own combination for personal use
- Use key for emergency unlock without knowing the preset combination
- Use key for decode the preset combination
- Best use for management

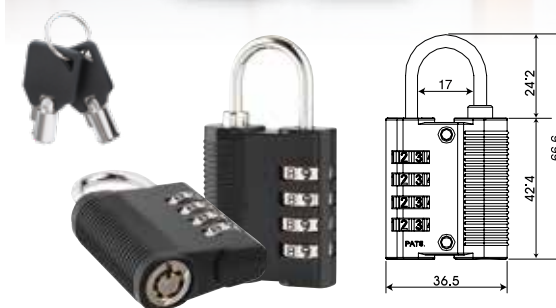
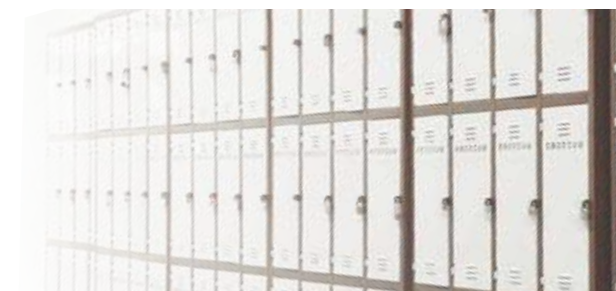

PL570 Window Dial™
Shackle size: Ø3.8 mm
W36.5 x D16 x H66.6 mm



PL571
Shackle size: Ø4.8 mm
W39 x D16 x H74.7 mm



PL575
Shackle size: Ø6.3 mm
W41.5 x D18.5 x H81.6 mm

iPad Lock

- Available for iPad Air
- Different viewing angles with a convenient handle
- Available with various cable locking solutions



Universal Tablet Lock

- Easy to install and dismount
- Fit tablets from 7" to 13" in max. thickness 11mm

